

Constant Voltage LED DALI Dimmer

- 1 DALI address, 1 channel constant voltage output.
- DALI-2 certified, in accordance with DALI standard protocol IEC 62386-101, 102, 207 and in compliance with DALI products from other international incorporation.
- DALI address will be automatically assigned by DALI master.
- PWM digital dimming, standard DALI logarithmic dimming curve.
- 3 kinds of PWM frequency by SET key setting: 2KHz,8KHz,16KHz.
- DALI signal input port supports AC push switch dimming.
- Over-heat /Short circuit protection, recover automatically.

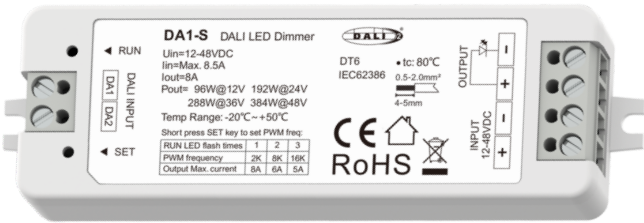

Technical Parameters

Input and Output		Dimming data		Safety and EMC	
Input voltage	12-48VDC	Input signal	DALI, AC Push	EMC standard	EN IEC 55015:2019+A11:2020 EN 61547:2009 EN IEC 61000-3-2:2019+A1:2021 EN 61000-3-3:2013+A1:2019
Input current	Max 8.5A	Dimming range	0 - 100%	Safety standard	EN 61347-1:2015+A1:2021 EN 61347-2-13:2014+A1:2017
Output voltage	12-48VDC	Dimming curve	Logarithmic	Certification	CE DALI-2
Output current	8A	PWM Frequency	2KHz (default)/8KHz/16KHz	Package & Warranty	
Output power	96W@12V 192W@24V 288W@36V 384W@48V	Environment		Size	L114xW38xH26mm
Output type	Constant voltage	Operation temperature	Ta: -20℃ ~ +50℃	Gross weight	0.058kg
		Case temperature (Max.)	Tc: +80℃	Warranty	5 years

Mechanical Structures and Installations

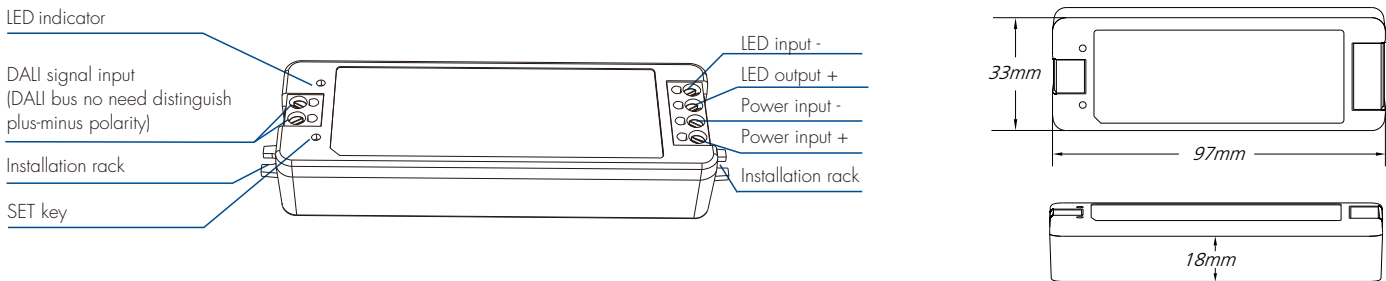

Wiring Diagram

- DA1-S connect with DALI master

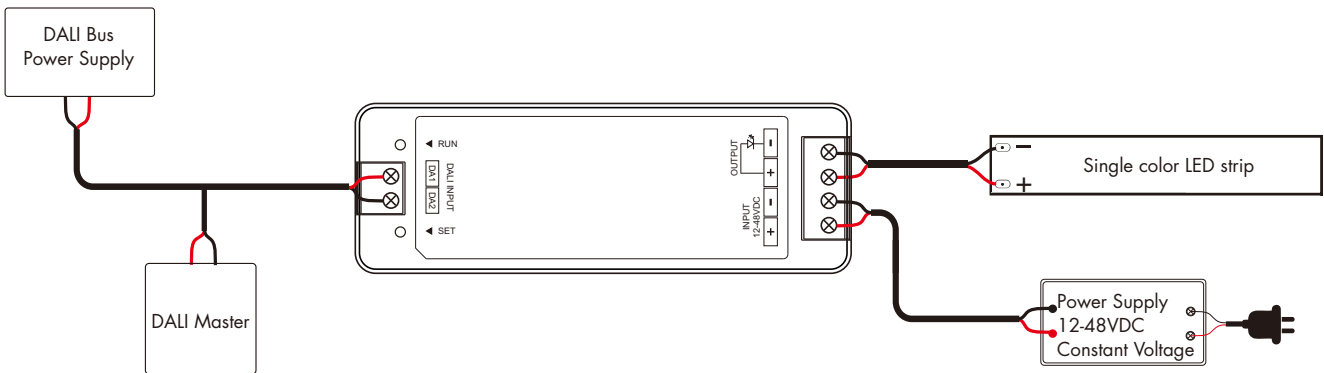

- DA1-S connect with push switch

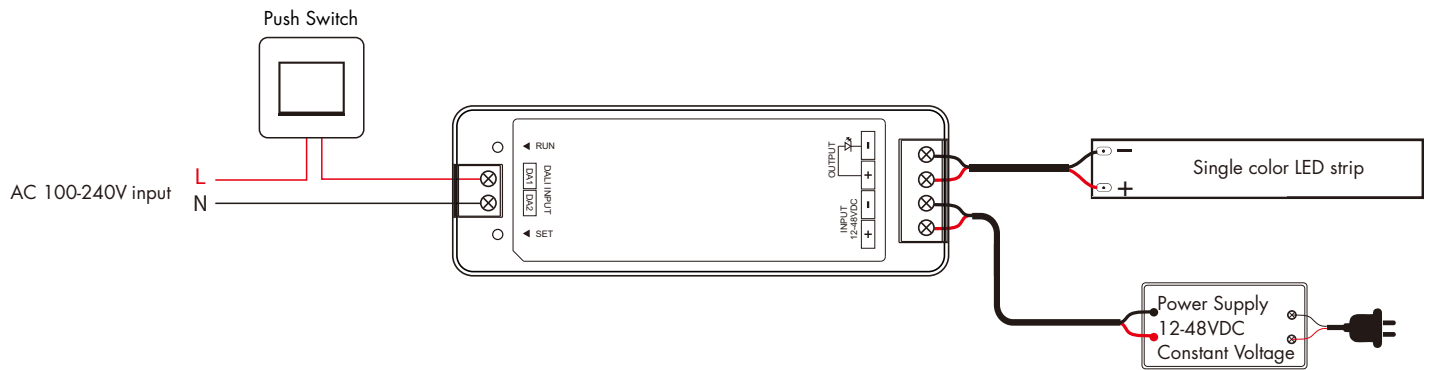

Note:

- When connecting the push switch, the fire wire (L) and zero wire (N) are connected to DA1 and DA2 respectively.
- The DALI interface is compatible with the push switch interface, DALI and push switch can only be connected to one, not at the same time.

PWM frequency setting

Short press SET key to switch 3 PWM frequencies sequentially:

2KHz (indicator blinks once),

8KHz (indicator blinks twice),

16KHz (indicator blinks three times).

Higher PWM frequency, will cause lower output current, higher power noise, but more suitable for camera(No flickers for video).

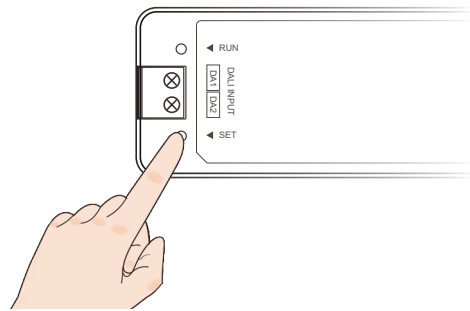

DALI control

DALI Address Assigned by DALI Master

DALI address is assigned by DALI Master controller automatically, please refer to user manuals of compatible DALI Masters for specific operations.

LED Indicator

- When the controller is power up, the LED indicator is always green.
- The LED indicator blinks once for each frame of DALI signal received.
- If the controller is faulty, the LED indicator flash green continuously.

Push Dim Function

The provided Push-Dim interface allows for a simple dimming method using commercially available non-latching (momentary) wall switches.

- **Short press:**
Turn on or off light.
- **Long press (1-6s):**
Press and hold to stepless dimming, With every other long press, the light level goes to the opposite direction.
- **Dimming memory:**
Light returns to the previous dimming level when switched off and on again, even at power failure.
- **Synchronization:**
If more than one controller are connected to the same push switch, do a long press for more than 10s, then the system is synchronized and all lights in the group dim up to 100%.
This means there is no need for any additional synchrony wire in larger installations.
We recommend the number of controllers connected to a push switch does not exceed 25 pieces,
The maximum length of the wires from push to controller should be no more than 20 meters.

Safety & Warnings

- DO NOT install with power applied to device.
- DO NOT expose the device to moisture.