

3-Button WiFi & IR RGBW LED Controller

Model No.: F4-D(WT)

4 channels constant voltage / Tuya APP cloud control / Voice control / 3-button / Step-less dimming / IR remote control

Features

- WiFi & IR 4 channels constant voltage RGBW LED controller.
- Tuya APP cloud control, support on/off, RGB color, brightness adjust, delay turn on/off light, timer run, scene edit and music play function.
- Voice control, support for Amazon Alexa, Google Assistant, Tmall Genie and Xiaodu smart speakers.
- 1.5A per channel, output connects with 5 meters RGBW LED strip.
- 3 buttons operation with on/off, mode and color adjustment.
- 256 levels 0-100% dimming smoothly without any flash.
- Built in 10 dynamic modes, include jump or gradual change style.



Technical Parameters

CE RoHS

Input and Output		Dimming data		Safety and EMC	
Input voltage	5-24VDC	Input signal	Tuya APP + IR + 3 button	EMC standard (EMC)	ETSI EN 301 489-1 V2.2.3 ETSI EN 301 489-17 V3.2.4
Output voltage	5-24VDC	Control distance	10m(Barrier-free space)	Safety standard	EN 62368-1:2020+A11:2020
Output current	4CH, 1.5A/CH	Dimming gray scale	256 level	Radio Equipment(RED)	ETSI EN 300 328 V2.2.2
Output power	30W@5V 72W@12V 144W@24V	Dimming range	0-100%	Certification	CE,EMC,RED
Environment		Dimming curve	Logarithmic	Package	
Operation temperature	Ta: -30 °C ~ +50 °C	PWM Frequency	2KHz (default)	Size	W130 x L60 x H26mm
Case temperature (Max.)	Tc: +80 °C	Warranty	5 years	Gross weight	0.079kg
		Protection	Over heat		

Dimension

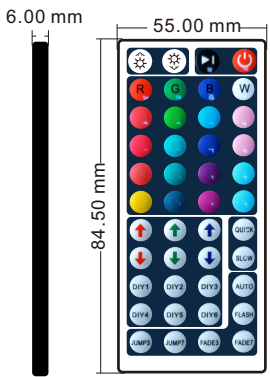
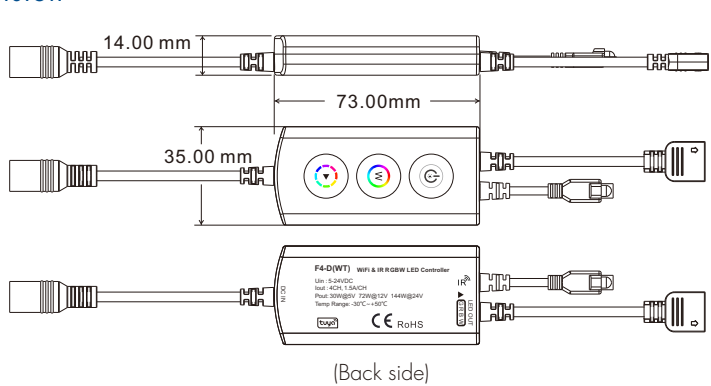

Wiring Diagram

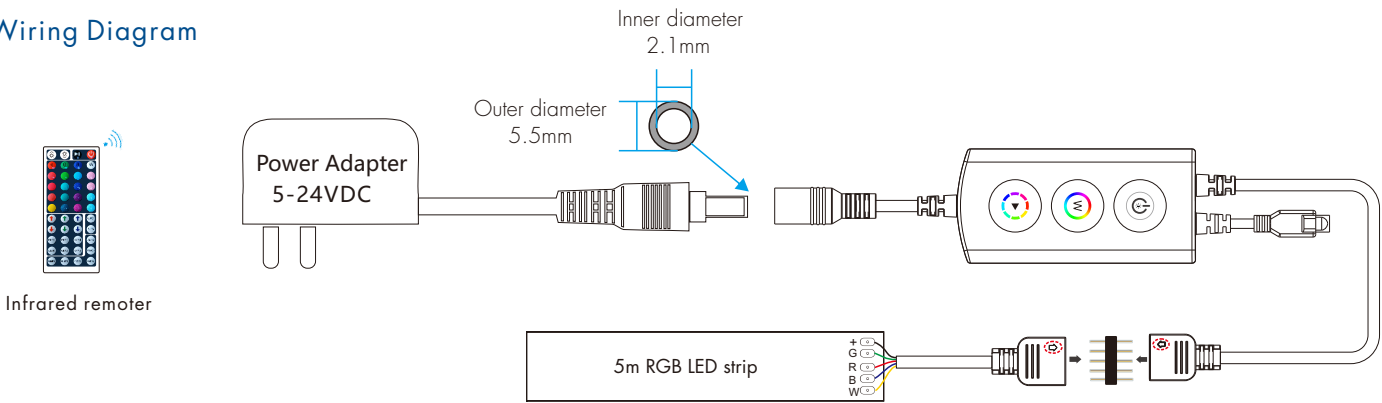

- Note:
1. Press and hold the and button for 2s, output LED flashes 3 times, the light on/off fade time will change between 3s and 0.5s.
 2. Press and hold the , , and button for 2s, output LED flashes multiple times, switch between "GRBW" (flashes 1 times), "RGBW" (flashes 2 times), and "GRWB" (flashes 3 times) output sequences, default is GRBV.

System wiring

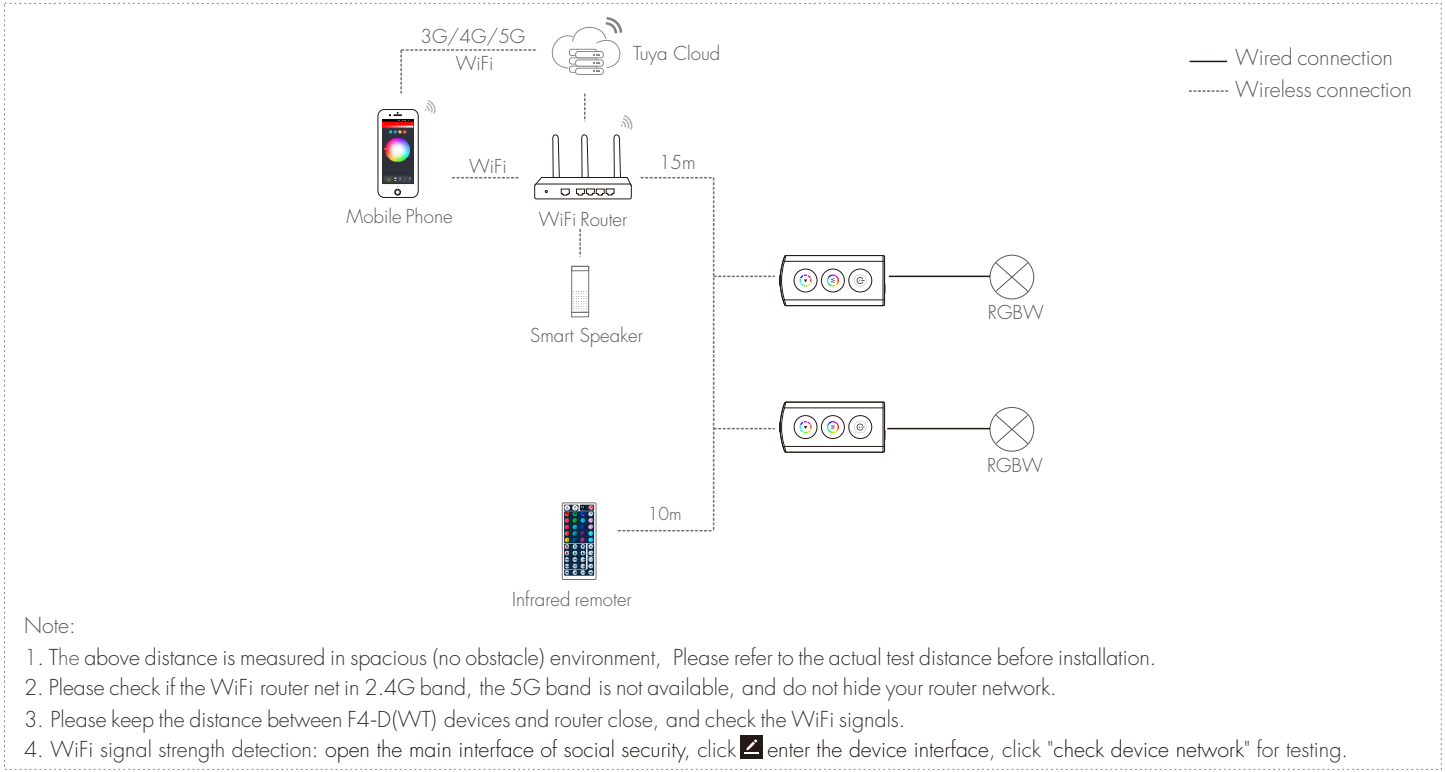

Button function

- : Short press to turn on or off light, long press 1-6s to adjust 256 levels brightness continuously.
- : Short press to switch between White or RGB colours.
When in White state, press and hold for 1-6s to continuously adjust White brightness.
When in RGB colour state, press and hold to switch between 24 kinds static RGB colours.
- : Short press to change 10 dynamic mode, long press 2s to adjust speed, 10 levels.

Dynamic mode list:

No.	Name	No.	Name
1	RGB jump	6	RGB fade in and out
2	RGB smooth	7	Red fade in and out
3	6 color jump	8	Green fade in and out
4	6 color smooth	9	Blue fade in and out
5	Yellow cyan purple smooth	10	White fade in and out

Tuya APP network connection

Please download the corresponding tuyu/smart life app according to your region.

Press and hold and button for 2s:
clear previous network connection, enter Smart config mode, the output LED will flash 10 times.

Press and hold and button for 5s:
Clear previous network connection, enter AP config mode, the output LED will flash 5 times.
If smart config failed, please try AP config.

Repeat power on and off for 5 consecutive times, also clear previous network connection,
enter Smart config mode, the output LED will flash 10 times.

If Tuya APP network connection succeed, the output LED will stop flash,
and in Tuya APP, you can find RGBWc device .



Smart life APP



Tuya Smart

Tuya APP interface

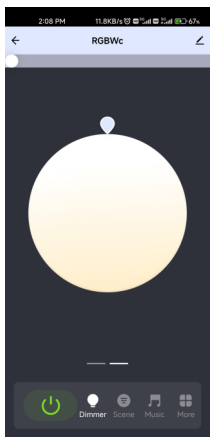

White interface

Touch the brightness slide to adjust the white light brightness.

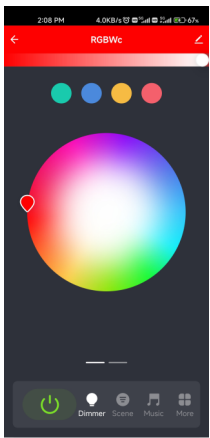

Colour interface

Touch color circle to adjust static RGB color.
Touch brightness slide to adjust color brightness.

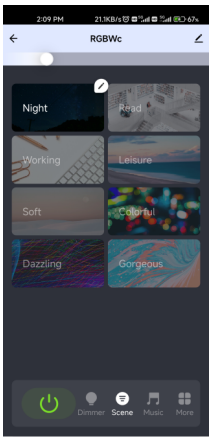

Scene interface

The 1-4 scene is static color.
the inner color of these scene can be editable.

The 5-8 scene is dynamic mode, such as green fade in and fade out,
RGB jump, 6 color jump, 6 color smooth.

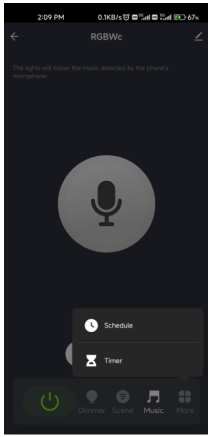
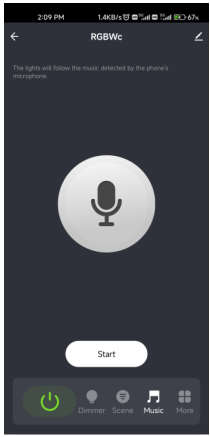

Music, Schedule, Timer

The music play can use smart phone music player or microphone as music signal input.

The Schedule key can add multiple timers to turn on or turn off light according to different time periods.

The Timer key can turn on or turn off light in the next 24 hours.

Key function of remote controller



- Turn on/off light.
- Pause/run dynamic mode (only use for dynamic mode); short press pause dynamic mode and stay at the current color; short press again, dynamic mode continues running.
- Short press to adjust brightness, 10 levels; long press for continuous adjustment, 256 levels.
- Short press to get red green or blue light directly; Long press 1-6s to adjust R/G/B channel brightness continuously to achieve millions of colors.
- Short press to get white light, long press 1-6s for continuous 256 levels of white brightness adjustment.
- Dynamic mode cyclic operation.

Get 16 kinds of static RGB colors directly.

- Short press to adjust brightness of red color, 10 levels; long press 1-6s for continuous adjustment, 256 levels.
- Short press to adjust brightness of green color, 10 levels; long press 1-6s for continuous adjustment, 256 levels.
- Short press to adjust brightness of blue color, 10 levels; long press 1-6s for continuous adjustment, 256 levels.
- For dynamic mode, short press to adjust speed, 10 levels, long press 2s to get the fastest or slowest.
- Short press to recall the scene, long press 2s to save the current color into DIY1/2/3/4/5/6.

— RGB jump mode

— RGB fade in and out mode

— 6 colors smooth mode

— 6 colors jump mode

— White fade in and out mode

Dimming curve

