

- Used for RF RGB/RGBW SPI LED controller.
- Ultra sensitive RGB color adjustment touch wheel.
- Support to set the color, change type, motion direction, speed, brightness of the dynamic mode.
- Support to set LED strip length, chip type, R/G/B/W color sequence.
- 8 scene memory.
- AAAx2 battery powered.
- Operate with LED indicator light.



FC CE RoHS

Technical Parameters

Input and Output		Safety and EMC		Environment	
Output signal	RF 2.4GHz	EMC standard	EN IEC 55015/EN IEC 61547ETSI EN 301 489-1/-3	Operation temperature	Ta: -30℃ ~ +55℃
Working voltage	3VDC(AAAx2)			IP rating	IP20
Working current	<8mA	Safety standard	EN 61347-1/-2EN 62493	Package	
Standby current	<7μA	Radio Equipment	ETSI EN 300 440	Size	L140 x W60 x H26mm
Remote distance	30m(Barrier-free space)	Certification	CE RoHs FCC	Gross weight	0.088kg
Standby time	1 year	Warranty	5 years		

Mechanical Structures and Installations

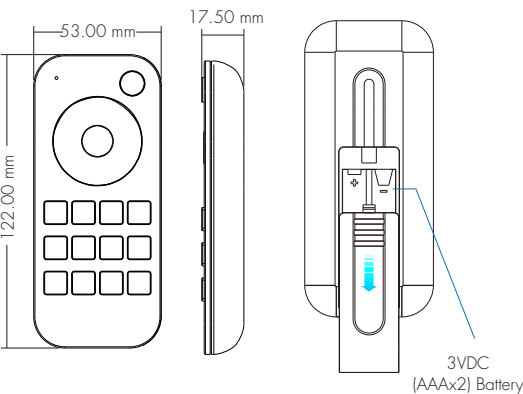

Back Holder

Two options are offered for selection, please fix the back holder on the wall with two screws, or adhere the back holder to the wall with paster.

1. Back holder without magnet

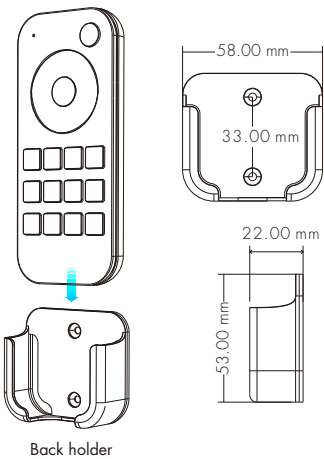

2. Back holder with magnet

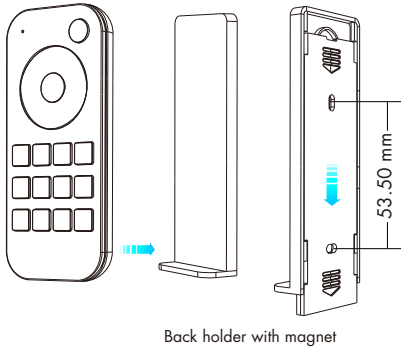

Match Remote Control

End user can choose the suitable match/delete ways. Two options are offered for selection:

Use the controller's Match key

Match:  
Short press match key,  
immediately press on/off key of the remote.  
The LED indicator fast flash a few times means match is successful.

Delete:  
Press and hold match key for 5s to delete all match,  
The LED indicator fast flash a few times means all matched remotes were deleted.

Use Power Restart

Match:  
Switch off the power, then switch on power, repeat again.  
Immediately short press on/off key 3 times on the remote.  
The light blinks 3 times means match is successful.

Delete:  
Switch off the power, then switch on power, repeat again.  
Immediately short press on/off key 5 times on the remote.  
The light blinks 5 times means all matched remotes were deleted.



- Turn on/off light.
- Touch to change static RGB color.
- Short press: Switch the color of the dynamic mode in sequence (e.g. Red, Orange, Yellow, Green, Cyan, Blue, Purple, White, R/G/B 3-color, 7-color).  
Long press for 2s: Set 6 levels of color saturation (80%, 60%, 40%, 20%, 0%, 100%) in sequence, i.e., transition the current color to RGB mixed white.
- Short press: Switch the change types of the dynamic modes in sequence (e.g. static, flow, chasing light, pile-up, floating, tail dragging, tail dragging + black segment, bouncing, shuttle, jump, fade, breath, flashing, chaotic flashing).  
Long press for 2s: Set the first change type (static).
- Short press: Switch 10 levels of speed in sequence.  
Long press for 2s: Switch the direction of light movement in sequence (e.g. forward, backward, round trip, both sides to center, center to both sides, curtains open and close).
- Short press: Switch 5 brightness levels in sequence (100%, 80%, 60%, 40%, 20%).  
Long press for 2s: Get maximum brightness 100%.
- 8 Scene storage.  
Short press: Call up scene 1-8.  
Long press 2s: Save the current lighting effect to scene 1-8.  
When saving is successful, the LED indicator is green.

**Note:** The remote control will automatically get the number of dynamic mode color, the number of change type, and the number of light movement direction from the SPI controller.

## Use Remote Set SPI Digital LED Strip

Long press key and key for 2s to enter the parameter setting state and the LED indicator turns green.

Short press key or touch the RGB color ring to exit the parameter setting status.

key correspond to the number 1-8, key correspond to the number 9, key correspond to the number 0, and key correspond to \*.

- Set LED strip length [Pixel number(8~1024)]. \* + 3 number + \*

Example: \*032\*: Set pixel number to 32. \*600\*: Set pixel number to 60. \*1024\*: Set pixel number to 1024.

- Set LED strip chip type. \* + 2 number + \*

\*11\*: TM1803  
 \*12\*: TM1809, TM1804, TM1812, UCS1903, UCS1909, UCS1912, SK6813, UCS2903, UCS2909, UCS2912, WS2811, WS2812, WS2813, WS2815, SM16703P  
 \*13\*: TM1829  
 \*14\*: TLS3001, TLS3002  
 \*15\*: GW6205  
 \*16\*: MBI6120  
 \*17\*: TM1814B(RGBW)  
 \*18\*: SK6812(RGBW), WS2813(RGBW), WS2814(RGBW)  
 \*19\*: UCS8904B(RGBW)  
 \*21\*: LPD6803, LPD1101, D705, UCS6909, UCS6912  
 \*22\*: LPD8803, LPD8806  
 \*23\*: WS2801, WS2803  
 \*24\*: P9813  
 \*25\*: SK9822  
 \*31\*: TM1914A  
 \*32\*: GS8206, GS8208  
 \*33\*: UCS2904  
 \*34\*: SM16804  
 \*35\*: SM16825  
 \*36\*: SM16714(RGBW)  
 \*37\*: UCS5603  
 \*38\*: UCS2603  
 \*39\*: SM16714D  
 \*41\*: UCS7604(RGBW)  
 \*42\*: UCS7804(RGBW)

- Set LED strip RGB order. \* + 1 number + \*

\*1\*: RGB, \*2\*: RBG, \*3\*: GRB, \*4\*: GBR, \*5\*: BRG, \*6\*: BGR

- Set RGBW LED strip RGB and W order.

\*7\*: W after RGB

\*9\*: W before RGB

Example: \*1\* + \*7\* set RGBW order, \*1\* + \*9\* set WRGB order.

## Installation Precautions

---

1. Please read all instructions carefully before starting the installation.
2. When installing the batteries, pay attention to the positive and negative poles of the batteries;  
please remove the batteries when you don't use the remote control for a long time;  
please replace the batteries in time when the distance of the remote control becomes smaller or the remote control fails frequently.
3. If the receiver does not respond, re-pair the remote control.
4. Hold it gently and avoid dropping it.
5. For indoor and dry environments only.
6. Avoid using it in large metal areas or areas with strong electromagnetic waves, otherwise the remote control distance will be affected.

### FCC ID Statement:

Mobile

RF Exposure Information

This equipment complies with FCC radiation exposure limits set forth for an uncontrolled environment.

This equipment should be installed and operated with minimum distance 20cm between the radiator and your body.

### IC ID Statement:

Mobile

This equipment should be installed and operated with minimum distance 20cm between the radiator & your body.

Cet équipement doit être installé et utilisé à une distance minimale de 20 cm entre le radiateur et votre corps.