

V1-KD

LED Knob Dimmer

Features

- Used for control single color constant voltage LED strips.
- Short press the knob to turn light on/off, rotate to adjust brightness.
- 4096 levels dimming smoothly without any flash.
- LED indicates the status during operation.
- Match with RF 2.4G single zone or multiple zone dimming remote control optional.
- Can be used as RF remote control, output RF 2.4G signal, remote control other RF LED controller or RF dimming driver.



RF DIM

CE RoHS

Technical Parameters

| Input and Output | | Dimming data | | Safety and EMC | |
|-------------------------|--|-------------------------|-------------------------|-----------------|--|
| Input voltage | 5-24VDC | Input signal | Knob + RF 2.4GHz | EMC standard | EN IEC 55015 EN IEC 61547 ETSI EN 301 489-1/-3 |
| Output voltage | 5-24VDC | Control distance | 30m(Barrier-free space) | Safety standard | EN 61347-1/-2 |
| Output current | 4A | Dimming gray scale | 4096 levels | Radio equipment | ETSI EN 300 440 |
| Output power | 20-96W | Dimming range | 0-100% | Certification | CE RoHS |
| PWM frequency | 2000Hz | | | | |
| Dimming curve | Logarithmic | | | | |
| Warranty and Protection | | Environment | | Package | |
| Warranty | 5 years | Operation temperature | Ta: -25°C ~ +55°C | Size | 110x57x28mm(LxVxH) |
| Protection | Reverse polarity, over-heat, short circuit | Case temperature (Max.) | Tc: +85°C | Gross weight | 0.054kg |
| | | IP rating | IP20 | | |

Mechanical Structures and Installations

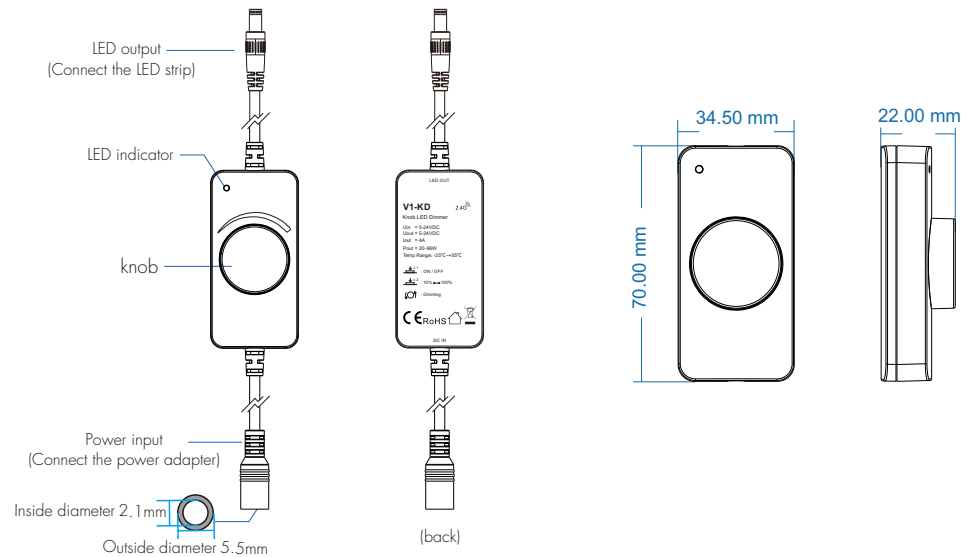

Wiring Diagram

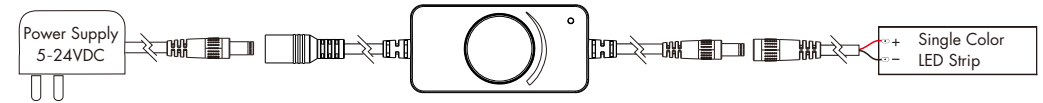

Knob Function

Short press: Turn on or off the light.

Double click: Switch between 10% and 100% brightness.

Rotation: Adjust brightness from 0% to 100% (1 turn, 21 levels).

V1-KD Match RF Remote Controller (Use Power Restart)

Match:

Switch off the power, then switch on power, repeat again.

Immediately short press on/off key (single zone remote)

or zone key (multiple zone remote) 3 times on the remote.

The light blinks 3 times means match is successful.

Delete:

Switch off the power, then switch on power, repeat again.

Immediately short press on/off key (single zone remote)

or zone key (multiple zone remote) 5 times on the remote.

The light blinks 5 times means all matched remotes were deleted.

V1-KD Used as RF Remote Controller

The V1-KD can be matched with one or more RF LED controllers/RF dimming drivers to remotely control other fixtures by knob.

For example, two V1-KD controllers are matched with each other for synchronized control.

End user can choose the suitable match/delete ways.

Use the controller's Match key

Match:

Short press the controller's match key,

immediately press the knob.

The LED indicator fast flash a few times means match is successful.

Delete:

Press and hold the controller's match key 5s,

The LED indicator fast flash a few times means all matched remotes were deleted.

Use Power Restart

Match:

Switch off the power of the controller, then switch on power, repeat again.

Immediately short press the knob 3 times.

The light blinks 3 times means match is successful.

Delete:

Switch off the power of the controller, then switch on power, repeat again.

Immediately short press the knob 5 times.

The light blinks 5 times means all matched remotes were deleted.

Dimming Curve

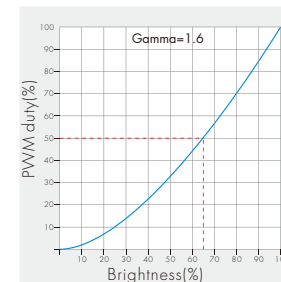

Packing List



LED Dimmer
1 pcs

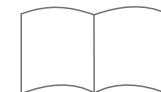

User Manual
1 pcs



DC Extension Cable
1 pcs