

V2-KD

CCT LED Knob Controller

Features

- Used for control CCT LED strips.
- Short press the knob to turn light on/off, rotate to adjust color temperature and brightness.
- 4096 levels dimming smoothly without any flash.
- LED indicates the status during operation.
- Match with RF 2.4G single zone or multiple zone CCT remote control optional.
- Can be used as RF remote control, output RF 2.4G signal, remote control other RF CCT LED controller or RF dimming driver.



CE RoHS

Technical Parameters

Input and Output		Dimming data		Safety and EMC	
Input voltage	5-24VDC	Input signal	Knob + RF 2.4GHz	EMC standard	EN IEC 55015 EN IEC 61547 ETSI EN 301 489-1/-3
Output voltage	5-24VDC	Control distance	30m(Barrierfree space)	Safety standard	EN 61347-1/-2
Output current	2CH, 2A/CH	Dimming gray scale	4096 levels	Radio equipment	ETSI EN 300 440
Output power	2x(10-48)W	Dimming range	0-100%	Certification	CE RoHS
PWM frequency	2000Hz				
Dimming curve	Linear				
Warranty and Protection		Environment		Package	
Warranty	5 years	Operation temperature	Ta: -25°C ~ +55°C	Size	110x57x28mm(LxWxH)
Protection	Reverse polarity, over-heat	Case temperature (Max.)	Tc: +85°C	Gross weight	0.054kg
		IP rating	IP20		

Mechanical Structures and Installations

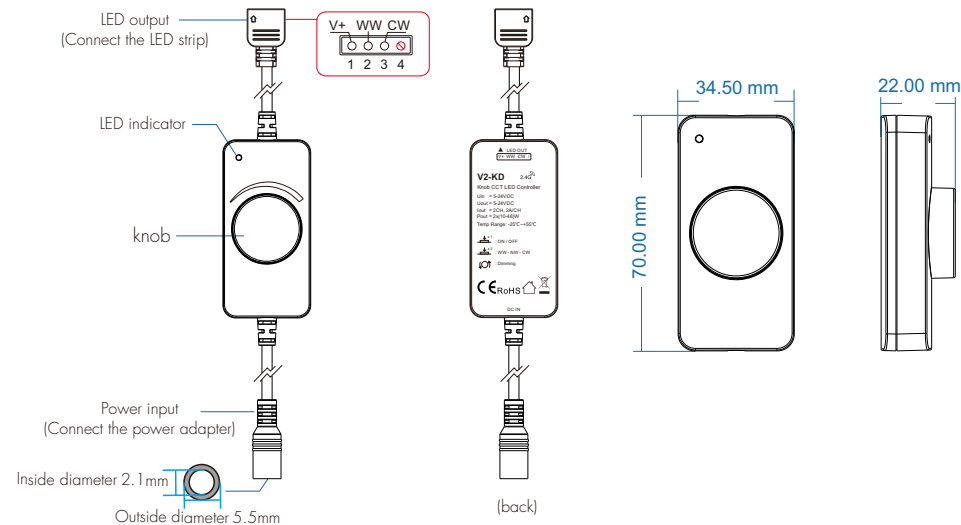

RF CCT

Wiring Diagram

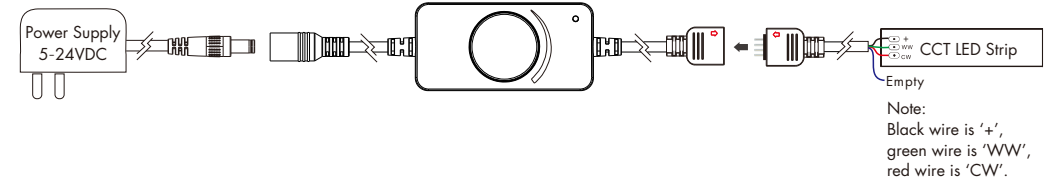

Knob Function

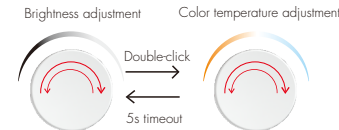

Short press: Turn on or off the light.

Double click: Sequentially switch the 3 levels of color temperature (Warm White - Neutral white - Cool White), at the same time enter knob adjust color temperature state. After 5 seconds of no operation, it automatically returns to knob adjust brightness state.

Rotation: When knob adjust brightness, rotate clockwise to increase brightness, rotate counterclockwise to decrease brightness (1 turn, 21 levels). When knob adjust color temperature, rotate clockwise to increase color temperature, rotate counterclockwise to decrease color temperature (1 turn, 21 levels). Adjust brightness by default.

V2-KD Match RF Remote Controller (Use Power Restart)

Match:

Switch off the power, then switch on power, repeat again. Immediately short press on/off key (single zone remote) or zone key (multiple zone remote) 3 times on the remote. The light blinks 3 times means match is successful.

Delete:

Switch off the power, then switch on power, repeat again. Immediately short press on/off key (single zone remote) or zone key (multiple zone remote) 5 times on the remote. The light blinks 5 times means all matched remotes were deleted.

V2-KD Used as RF Remote Controller

The V2-KD can be matched with one or more RF CCT LED controllers/RF dimming drivers to remotely control other fixtures by knob. For example, two V2-KD controllers are matched with each other for synchronized control. End user can choose the suitable match/delete ways.

Use the controller's Match key

Match:

Short press the controller's match key, immediately press the knob. The LED indicator fast flash a few times means match is successful.

Delete:

Press and hold the controller's match key 5s, The LED indicator fast flash a few times means all matched remotes were deleted.

Use Power Restart

Match:

Switch off the power of the controller, then switch on power, repeat again. Immediately short press the knob 3 times. The light blinks 3 times means match is successful.

Delete:

Switch off the power of the controller, then switch on power, repeat again. Immediately short press the knob 5 times. The light blinks 5 times means all matched remotes were deleted.

Dual Color Control

WW=Warm white LED CW=Cool white LED

Each channel can supply up to 48W(@24V) and color temperature can be controlled as such:

Color temperature	Cool white	Neutral white	Warm white
Power distribution	WW=0W, CW=48W	WW=24W, CW=24W	WW=48W, CW=0W

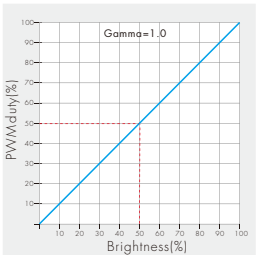
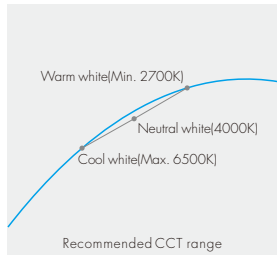

Packing List



LED Controller
1 pcs

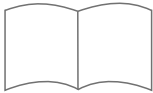

User Manual
1 pcs



Extension Cable
(12.5cm)
1 pcs