

# V3-KD

## RGB LED Knob Controller

### Features

- Used for control RGB LED strips.
- Short press the knob to turn light on/off, rotate to adjust RGB color and brightness.
- 4096 levels dimming smoothly without any flash.
- LED indicates the status during operation.
- Built-in 10 dynamic modes, include jump and fade.
- Match with RF 2.4G single zone or multiple zone RGB remote control optional.
- Can be used as RF remote control, output RF 2.4G signal, remote control other RF RGB LED controller or RF dimming driver.



CE RoHS

### Technical Parameters

Input and Output		Dimming data		Safety and EMC	
Input voltage	5-24VDC	Input signal	Knob + RF 2.4GHz	EMC standard	EN IEC 55015
Output voltage	5-24VDC	Control distance	30m(Barrier-free space)		EN IEC 61547
Output current	3CH, 1.5A/CH	Dimming gray scale	4096 levels	ETSI EN 301 489-1/-3	
Output power	3x(7.5-36)W	Dimming range	0-100%	Safety standard	EN 61347-1/-2
PWM frequency	2000Hz			Radio equipment	ETSI EN 300 440
Dimming curve	Logarithmic			Certification	CE RoHS
Warranty and Protection		Environment			
Warranty	5 years	Operation temperature	Ta: -25℃ ~ +55℃	Package	
Protection	Reverse polarity, overheat	Case temperature (Max.)	Tc: +85℃	Size	110x57x28mm(LxWxH)
		IP rating	IP20	Gross weight	0.054kg

### Mechanical Structures and Installations

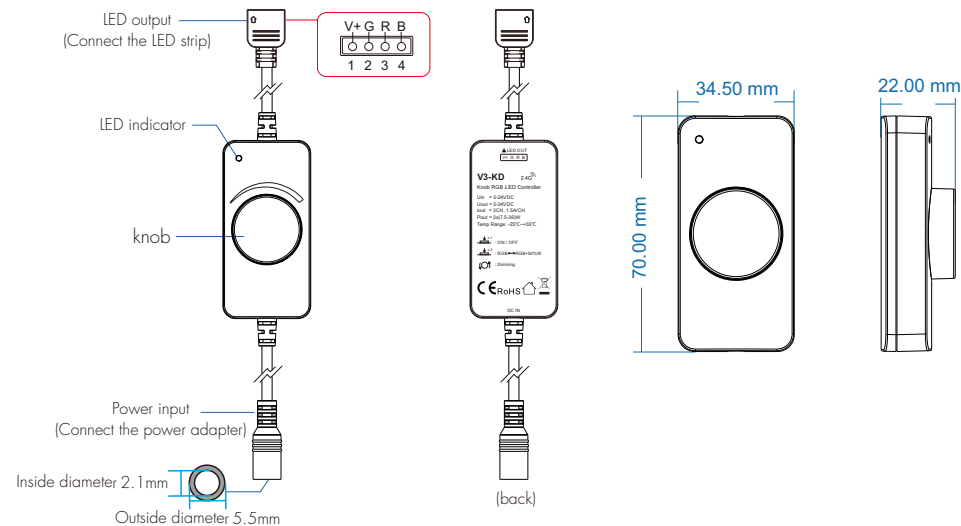

### Wiring Diagram



### Knob Function

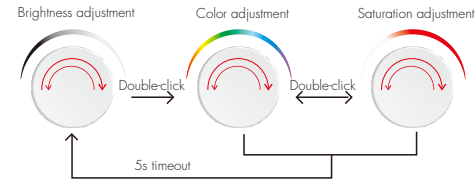

**Short press:** Turn on or off the light.

**Double click:** Switch between color light and mixed white light (mixed white light defaults to current color + 50% saturation). at the same time enter knob adjust color (red - yellow - green - cyan - blue - purple) or color saturation state. After 5 seconds of no operation, it automatically returns to knob adjust brightness state.

**Rotation:** When knob adjust brightness, rotate clockwise to increase brightness, rotate counterclockwise to decrease brightness (1 turn, 21 levels). When knob adjust color, rotate clockwise to change from red to purple, rotate counterclockwise to change from purple to red (3 turns, 60 levels). When knob adjust color saturation, rotate clockwise rotation decrease saturation, rotate counterclockwise to increase saturation (1 turn, 21 levels). Adjust brightness by default.

### V3-KD Match RF Remote Controller (Use Power Restart)

Match:

Switch off the power, then switch on power, repeat again. Immediately short press on/off key (single zone remote) or zone key (multiple zone remote) 3 times on the remote. The light blinks 3 times means match is successful.

Delete:

Switch off the power, then switch on power, repeat again. Immediately short press on/off key (single zone remote) or zone key (multiple zone remote) 5 times on the remote. The light blinks 5 times means all matched remotes were deleted.

### V3-KD Used as RF Remote Controller

The V3-KD can be matched with one or more RF LED controllers/RF dimming drivers to remotely control other fixtures by knob. For example, two V3-KD controllers are matched with each other for synchronized control. End user can choose the suitable match/delete ways.

#### Use the controller's Match key

Match:

Short press the controller's match key, immediately press the knob. The LED indicator fast flash a few times means match is successful.

Delete:

Press and hold the controller's match key 5s, The LED indicator fast flash a few times means all matched remotes were deleted.

#### Use Power Restart

Match:

Switch off the power of the controller, then switch on power, repeat again. Immediately short press the knob 3 times. The light blinks 3 times means match is successful.

Delete:

Switch off the power of the controller, then switch on power, repeat again. Immediately short press the knob 5 times. The light blinks 5 times means all matched remotes were deleted.

Dynamic Change Mode (called up by RF remote control)

No.	Name	No.	Name
1	RGB jump	6	RGB fade in and out
2	RGB smooth	7	Red fade in and out
3	6 color jump	8	Green fade in and out
4	6 color smooth	9	Blue fade in and out
5	Color temperature smooth	10	White fade in and out

Dimming Curve

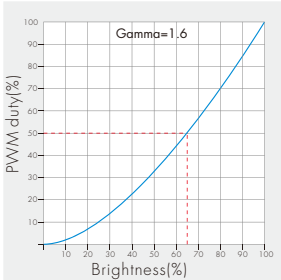

Packing List



LED Controller  
1 pcs

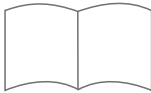

User Manual  
1 pcs



Extension Cable  
(12.5cm)  
1 pcs